

## LEGENDS & TERMINALS

**AR-62** Name plate  
Large



**AR-63** Ring type  
name plate  
Standard



**AR-65**  
Ant-revolution  
Ring for  
square type



**AR-66**  
Anti-Revolution  
Ring for  
Round type



**AR-81**  
Lamp  
replacement  
tool



**AR-82** Nut tightening tool



**HYT-10**

MODEL	SIZE	MONTING WIDTH	HOLE
HYT-1010	10A10P	102.5	3.7
SCREW	VOLTAGE	CURRENT	
M3	600V	10A	

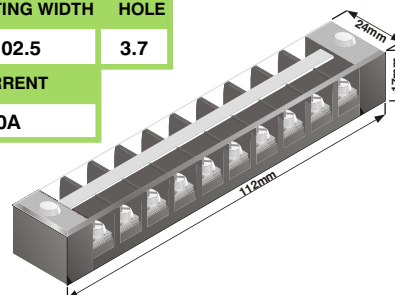

**AR-83** Lamp button  
replace tool



**HYBT-15**



**HYBT-15-2**



DIN RAIL TERMINAL  
BLOCKS

MODEL	VOLTAGE	CURRENT	SIZE
HYBT-15	600V	15A	3.6
HYBT-15-2			

**HYF15-3-220A**

Triple fuse holder with  
LED indication  
220VAC - 15A



45

**HYF15-1-24D**

**HYF15-1-220A**

Single fuse holder with  
LED indication.

24VDC - 10A  
220VAC - 15A



58

16

**HYBT15 - EP**

**HYBT15 - EP - 2**

END PLATE



**HYBT07**

STOPPER



**HYBT08**

COVER



TOP HAT DIN RAIL MOUNTING  
LED INDICATION OF FUSE FAILURE



41.2

## POWER PUSH BUTTON SWITCHES

**HY512**

Rating: 2P 250V 15A  
Usage: 1 phase switching



**HY513**

Rating: 3P 250V 15A  
Usage: 3 phase switching

**HY512 S**

Rating: 2P 250V 15A - Lamp s/w 2A  
Usage: 1 phase switching

**HY513 S**

Rating: 3P 250V 15A - Lamp s/w 2A  
Usage: 3 phase switching

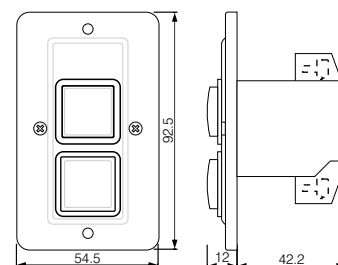

## HOIST SWITCHES

Rating: 250VAC 5A  
(IP65)

### 102T

2 Speed contact for 2 pushbuttons

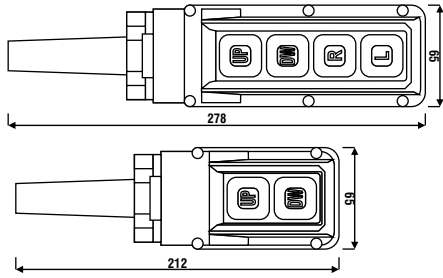

### HY-1022

2 CONTACT

### HY-1024

4 CONTACT

### HY-1026

6 CONTACT

### HY-1028

8 CONTACT



## PROXIMITY SENSORS

### DC SENSOR, SQUARE TYPE

CODE	HYP-18S5	HYP-25S12	HYP-30S15
SENSING DISTANCE	5mm±10%	12mm±10%	15mm±10%
MOUNTING DISTANCE	0 ~ 4mm	0 ~ 9.6mm	0 ~ 12mm
OBJECT	STEEL 18x18x1	STEEL 35x35x1	STEEL 45x45x1
SWITCHING FREQUENCY	500Hz	200Hz	100Hz
OUTPUT CURRENT	MAX. DC 200mA		
POWER	DC12~24V(DC10~30V)		
RESIDUAL VOLTAGE	1V MAX.		
POWER CONSUMPTION	DC 10mA MAX.(DC12V)		
LEAKAGE CURRENT	DC 0.5mA MAX.		
INSULATION RESISTANCE	500M MIN. AT DC 500V		
DIELECTRIC STRENGTH	AC 1000V FOR 1 MINUTE		
AMBIENT TEMPERATURE	-25°C ~ 70°C		
DEGREE OF PROTECTION	IP67 (IEC)		
PROTECTION CIRCUIT	SURGE PROTECTION / REVERSE POLARITY PROTECTION		
OPERATION LAMP	RED (LED)		
VIBRATION	10 ~ 55Hz DOUBLE AMPLITUDE 1.5mm X.Y.Z. EACH DIRECTION FOR 2 HOURS		
SHOCK	500 m / s <sup>2</sup> (APPROX. 50g) X.Y.Z. EACH DIRECTION FOR THREE TIMES		
MATERIAL	CASE: ABS RESIN, FACE: ABS RESIN		

SUITABLE FOR VARIOUS LIMIT & COUNTING CONTROL  
SENSORS ARE TOTALLY SEALED & CAN OPERATE  
IN THE MOST DEMANDING ENVIRONMENTS  
200mA MAXIMUM CONTROL OUTPUT  
REVERSE POLARITY PROTECTION  
SURGE PROTECTION

HYP-18S5PAF  
HYP-18S5PAU  
HYP-18S8PAF  
HYP-18S8PAU

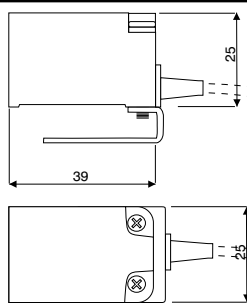
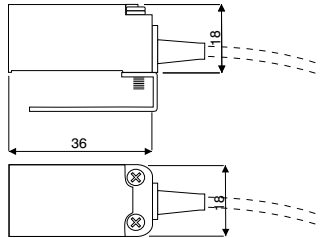

### HYP-25S12PAF

### HYP-30S15PA

### HYP-25S5PAF



**EX INDENT AVAILABLE TYPES INCL.:** ROUND METAL, PNP, AC & CAPACITIVE TYPES.  
FUTURE EDITIONS OF OUR CATALOGUE WILL CONTAIN MORE INFO. & SPECS ON SENSORS.