

LED LAMP REPLACEMENTS

SUPERBRIGHT SINGLE CHIP TECHNOLOGY BA9s LED LAMPS

ALTO - BRITE

FEATURES

- Part No: **A09BA1 - (voltage) - (colour)**
- Newest Technology
- Wide Viewing Angle 130° (Equivalent to Multichip Types)
- Vibration Resistant
- Low Power
- Long Life
- E10, E12 & E14 types available with similar specs.
- BiPolar (AC/DC) 24, 110 & 230V
- 5 Colours
(Red, True Green, Yellow, Real Blue or White)

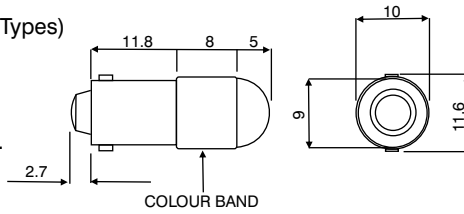

This product uses High efficiency Led materials. Every Lamp is made with an advanced optical grade epoxy offering superior high shock and temperature resistance. The 130° round radiation pattern and high luminous intensity ensure that these devices are perfect for applications where a wide field of view and readability in high ambient lighting conditions is required. These lamps are in some instances suitable for shaded outdoor operating conditions.



LED Lamp SISTRAR II

- Shock & vibration proof.
- Life expectancy (min 100,000 hours).
- Increased reliability through dispartment of the LED's in two split electrical circuits.
- Integrated over voltage protection.
- Power: 1 W at 24 V
- E14, BA15s or BA15d.
- 24/28V, 130V & 230VAC/DC
- Colours: Red, Green, Yellow, Blue or White.

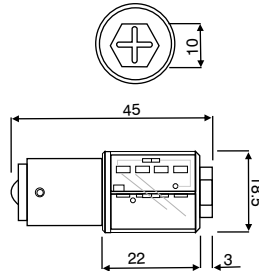

ALTO - SUPER BRITE MR16 LED

- Extra high bright reliability LED lamps.
- Wide viewing angle (30° or 60°)
- Energy saving and works more than 10 times longer than a halogen bulb.
- 12pcs 5mm/4.8mm LED lamps.
- MR16 GX5.3 bi - pins
- 12V AC/DC
- Colours: Red, Green, Yellow, Blue or White.

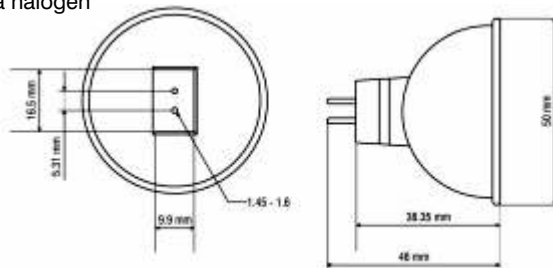

WARNING: These lamps must only be used with traditional transformers.

LED-Spot series MHAG 40 with optic Ø 35mm

- Same dimensions as standard halogen lamp with 8 integrated LED's & optical lenses.
- Life expectancy (min 50,000 hours = 6 years continuous operation).
- Energy saving, works more than 10 times longer than a halogen bulb.
- Power: 1W
- 12-14VAC/DC
- Brightness: ±40cd
- Colours: Red, Green, Yellow, Blue or White.

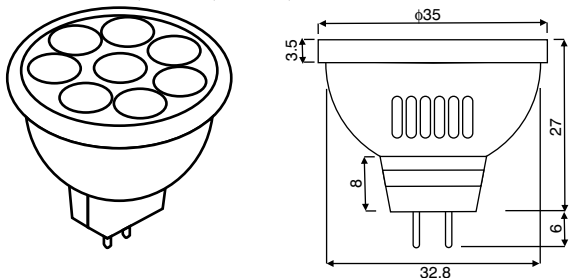

WARNING: These lamps must only be used with magnetic transformer

LED-Spot series MHCG 53 with optic Ø 50mm

- Same dimensions as standard halogen lamp - with 15 intergrated LED's & optical lenses.
- Life expectancy (min 50,000hrs=6yrs continuous operation).
- Energy saving, works more than 10 times longer than a halogen bulb.
- Power : 12V=1.2W/28V=2.4W
- 12-28VAC/DC
- Brightness: ±90cd
- Colour: Red, Green, Yellow, Blue or White.

